



## GOAT BUILT PASSENGER ALTERNATOR RELOCATION BRACKET

Thank you for purchasing Goat Built components, before starting your installation, we recommend that you read through these instructions to familiarize yourself with the steps and parts so you can plan and prepare for your install accordingly.

A few notes about the 4408 P-pump bracket:

- This bracket kit is intended for 99 to current GM truck Vortec 4.8/5.3/6.0 pulley spacing
  - This bracket was designed to be used in conjunction with the Goat Built 4405 passenger side alternator bracket/tensioner
  - The **belt length** varies based on which alternator you are using and which power steering pump, bracket and pulley diameter you are using. When using a P- pump with a 6.5" pulley, Goat Built 4405 alternator bracket and late model alternator, a 84.5" belt works. Based on these components, you can estimate the belt length for your specific configuration.
1. Loosely install all the brackets, pump and bolts before you fully tighten any of the bolts.
  2. Remove any bolts that attach the pump reservoir can to the back of the pump.
  3. Install the 4408-02 brackets to the back of the pump using the M10 x 30 bolt and M10 x 35 flat head bolt with the appropriate spacers. Tighten these bolts to 40 ft-lbs
  4. Install the 4408-02 bracket and pump to the head using the single M10 x 25 bolt, make sure the other holes in the bracket are aligned with the threaded holes in the head, this bracket goes against the head with no spacers.
  5. Install the 4408-01 bracket using the M10 x 120 bolts and the 3.600" spacers to the head and 4408-02 bracket
  6. Install the two M10 x 35 bolt with the .627" spacer through the 4408-01 bracket into the front of the pump
  7. Torque the 10 MM bolts to 40 ft-lbs
  8. Remove the factory spacer from the idler, if equipped. Install the idler to the front of the 4408-01 bracket using the new 4400-04 bearing spacer, 1/2" flange bolt and flange lock nut.
  9. Install the belt as shown below.

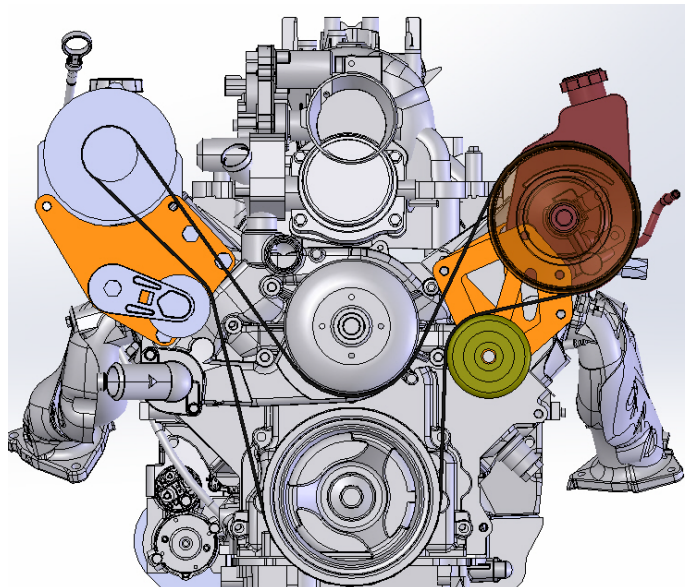

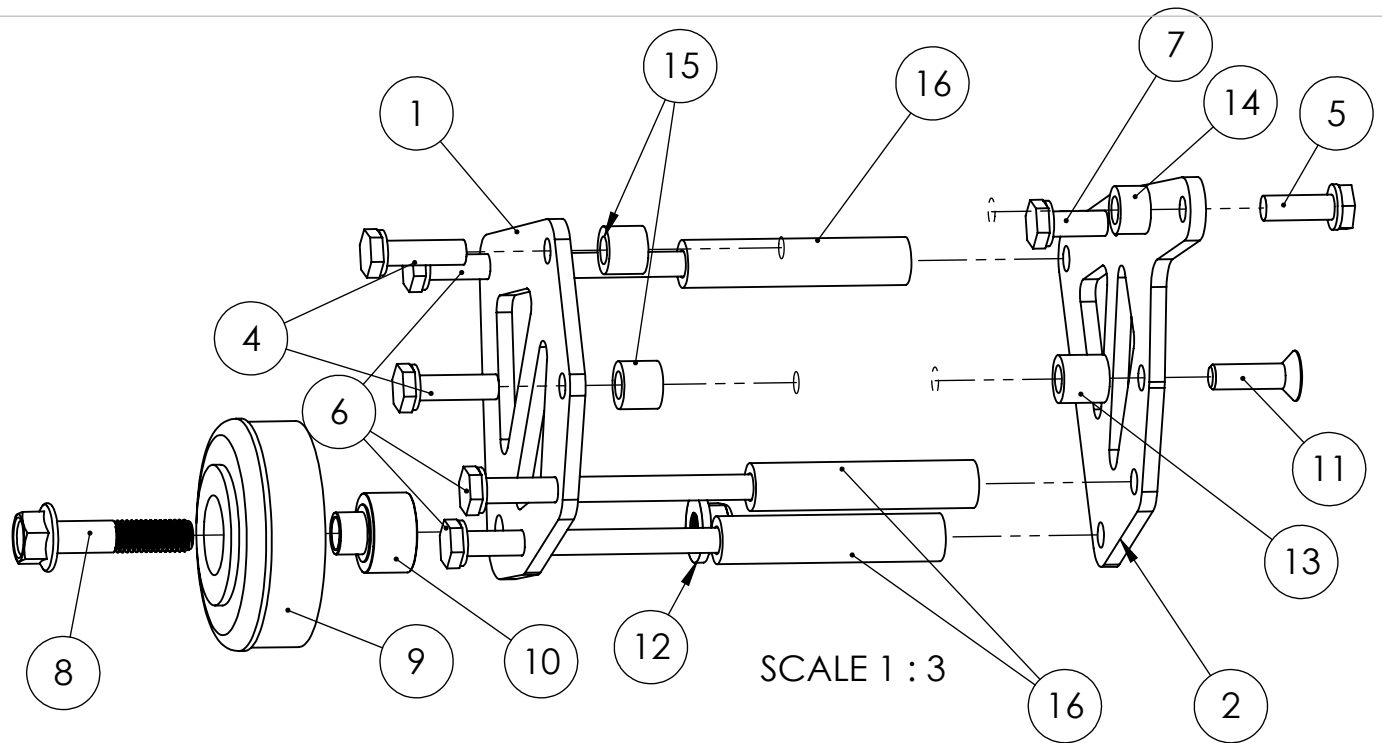
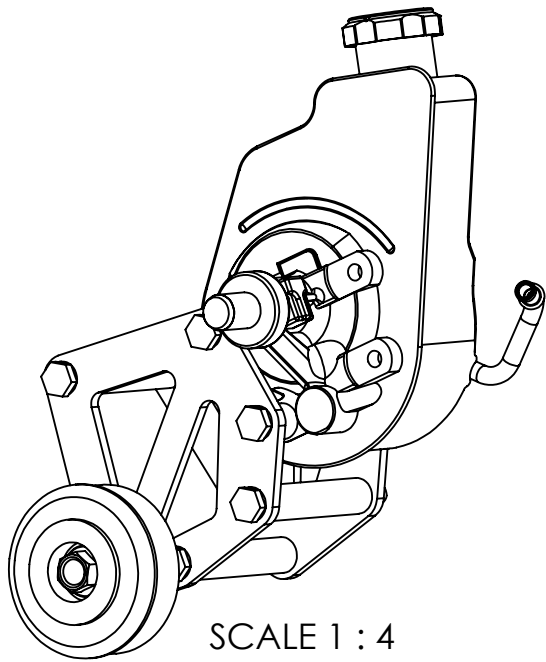

| ITEM NO. | PART NUMBER     | DESCRIPTION              | Default/<br>QTY. |
|----------|-----------------|--------------------------|------------------|
| 1        | 4408-01         | FRONT BRACKET            | 1                |
| 2        | 4408-02         | REAR BRACKET             | 1                |
| 3        | TRUCK PUMP ASSY | P PUMP                   | 1                |
| 4        | 35              | M10 X 35 BOLT            | 2                |
| 5        | 30              | M10 X 30 BOL;T           | 1                |
| 6        | 120             | M10 X 120 BOLT           | 3                |
| 7        | 25              | M10 X 25 BOLT            | 1                |
| 8        | IDLER BOLT      | 1/2 FLANGE BOLT          | 1                |
| 9        | IDLER           | GM TRUCK IDLER           | 1                |
| 10       | 4400-04         | IDLER SPACER             | 1                |
| 11       | 35              | M10 X 35                 | 1                |
| 12       | 92018A540       | 1/2" UNC FLANGE LOCK NUT | 1                |
| 13       | 4400-0733       | .733" SPACER             | 1                |
| 14       | 4400-0488       | .488 SPACER              | 1                |
| 15       | 4400-0627       | .627 SPACER              | 2                |
| 16       | 4400-3600       | 3.600" SPACER            | 3                |



TITLE:  
**DRIVER SIDE TC PUMP  
 BRACKET, TRUCK**

SIZE DWG. NO.  
**A 4408**

SCALE: 1:1 WEIGHT: SHEET 1 OF 1